



OWNER'S MANUAL

使用说明书

DIGITAL PORTABLE RADIO

数字手持终端

DIGITAL TRUNKING PORTABLE RADIO

数字集群手持终端





Preface

Thanks for your favor in our product. This manual is helpful for you to quickly know how to use the product. For detailed features and operations, please refer to the Feature Description and Operation Manual along with the product.

To avoid body injury or property loss caused by misoperation, please read the Safety Information Booklet carefully before use.

This manual is applicable to the following product:

PD702i Digital Portable Radio

Icon Conventions



Indicates functions that are available on digital channel only.



Indicates functions that are available on analog channel only.

Functions marked with no icon are available on both analog and digital channels.

Disclaimer

Hytera Communications Corporation Limited (the Company) endeavors to achieve the accuracy and completeness of this manual, but no warranty of accuracy or reliability is given. All the specifications and designs are subject to change without notice due to continuous technology development. No part of this manual may be copied, modified, translated, or distributed in any manner without the express written permission of us.

We do not guarantee, for any particular purpose, the accuracy, validity, timeliness, legitimacy or completeness of the Third Party products and contents involved in this manual.

If you have any suggestions or would like to learn more details, please visit our website at: <http://www.hytera.com>.

RF Radiation Information

This product must be restricted to operations in an occupational/controlled RF exposure environment. Users must be fully aware of the hazards of the exposure and able to exercise control over their RF exposure to qualify for the higher exposure limits.

RF Radiation Profile

Radio Frequency (RF) is a frequency of electromagnetic radiation in the range at which radio signals are transmitted. RF technology is widely used in communication, medicine, food processing and other fields. It may generate radiation during use.

RF Radiation Safety

In order to ensure user health, experts from relevant industries including science, engineering, medicine and health work with international organizations to develop standards for safe exposure to RF radiation. These standards consist of:

- United States Federal Communications Commission, Code of Federal Regulations; 47CFR part 2 sub-part J;
- American National Standards Institute (ANSI)/ Institute of Electrical and Electronic Engineers (IEEE) C95.1-1992;
- Institute of Electrical and Electronic Engineers (IEEE) C95.1-1999;
- International Commission on Non-Ionizing Radiation Protection (ICNIRP) 1998;

FCC Regulations

Federal Communication Commission (FCC) requires that all radio communication products should meet the requirements set forth in the above standards before they can be marketed in the U.S, and the manufacturer shall post a RF label on the product to inform users of operational instructions, so as to enhance their occupational health against exposure to RF energy.

Operational Instructions and Training Guidelines

To ensure optimal performance and compliance with the occupational/controlled environment RF energy exposure limits in the above standards and guidelines, users should transmit not more than 50% of the time and always adhere to the following procedures:



- RF energy will be generated only when the radio is transmitting.
- The radio must be at least 2.5 centimeters away from human body when transmitting.

EU Regulatory Conformance

As certified by the qualified laboratory, the product is in compliance with the essential requirements and other relevant provisions of the Directive 1999/5/EC.

Please note that the above information is applicable to EU countries only.

Contents

Items in the Package	2
Product Overview	2
Product Controls	2
Programmable Keys	2
LED Indicator	2
Before Use	3
Attaching the Battery	3
Attaching the Antenna	3
Attaching the Belt Clip	3
Checking the Battery Power	4
Basic Operations	4
Turning the Radio On/Off	4
Adjusting the Volume	4
Selecting a Zone	4
Selecting a Channel	4
Call Services	4
Private Call 	5
Group Call 	5
Emergency Call	5
Available Features	5
Troubleshooting	6
Care and Cleaning	7
Optional Accessories	8

Items in the Package

Please unpack carefully and check if all items listed below are received. If any item is missing or damaged, please contact your dealer.

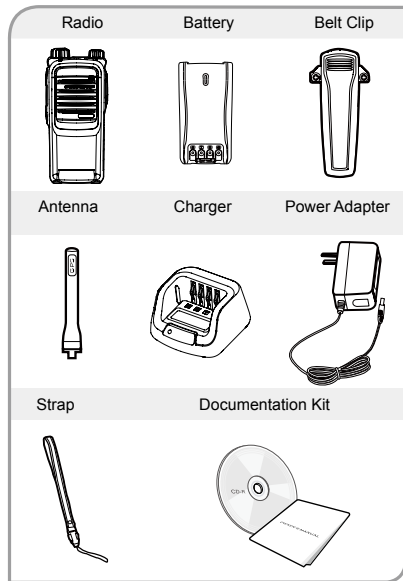

Note: The frequency band is marked on the label of antenna; if not, please refer to the label on the radio for frequency band information.

Product Overview

Product Controls

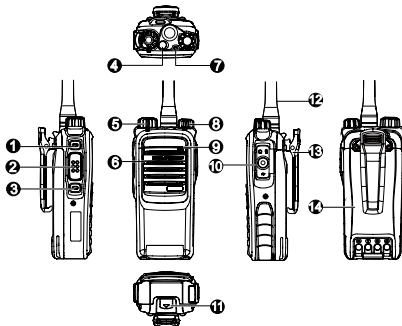

No.	Part Name	No.	Part Name
1	SK1 (Side Key 1)	8	Power On/Off/Volume Control Knob
2	PTT (Push-to-Talk) Key	9	Microphone
3	SK2 (Side Key 2)	10	Accessory Connector
4	TK (Top Key)	11	Battery Latch
5	Channel Selector Knob	12	Antenna
6	Speaker	13	Belt Clip
7	LED Indicator	14	Battery

Programmable Keys

For enhanced convenience, you may request your dealer to program the **SK1**, **SK2**, and **TK** (☺) as shortcuts to certain functions. Please refer to the Feature Description and Operation Manual along with the product for more details.



Caution: The **TK** key is programmed with emergency feature by default (short press: Emergency On; long press: Emergency Off). It is programmable by your dealer.

LED Indicator

LED Indication	Radio Status
The LED indicator flashes green.	Powering on
The LED indicator glows green.	Receiving
The LED indicator glows red.	Transmitting
The LED indicator flashes orange slowly.	Scanning or Roaming
The LED indicator flashes orange rapidly.	Emergency
The LED indicator glows orange.	Call hung period. No voice is being transmitted or received on the traffic channel during a call. Within such period, you can hold down the PTT key to talk to the other party.

Before Use

Attaching the Battery

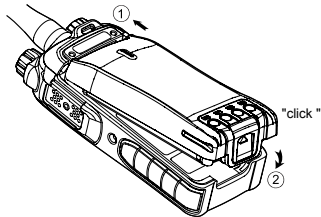

Note: To remove the battery, turn off the radio first, and then slide the battery latch upwards to unlock the battery.

Attaching the Antenna



Caution: Do not hold the radio by its antenna, otherwise the performance and lifespan of the antenna will be reduced.

Attaching the Belt Clip

Step 1 Remove the screws.

Step 2 Align the screw holes on the belt clip with those on the radio's back, and then tighten the screws.

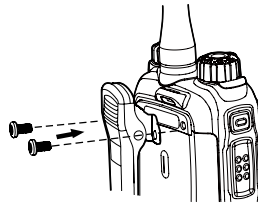

Attaching the Accessories

Step 1 Open the accessory connector cover as shown below.

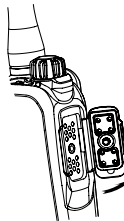

Step 2 Align the accessory (such as an audio accessory, or a programming cable) plug with the accessory connector.



Caution: Do not scrape the silicone rubber surrounding the accessory connector screw hole, in order to ensure the waterproof performance of the radio.

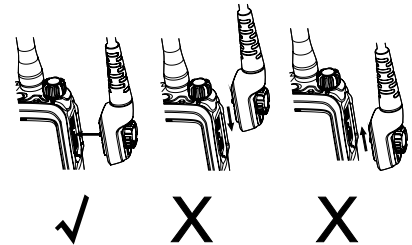

Step 3 Tighten the screw on the plug.

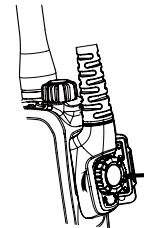

Charging the Battery



Caution:

- Use the charger specified by the Company to charge the battery.
- Make sure the radio is powered off before charging. Read the Safety Information Booklet in advance to get necessary safety information.
- Charge a new battery for at least 5 hours before initial use for best performance.

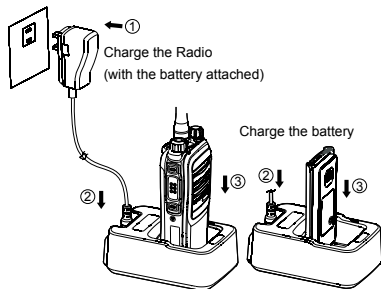

Charging Status Indication (on charger):

LED Indication	Charging Status
The LED Indicator flashes red slowly.	Standby (no load)
The LED Indicator glows red.	Charging
The LED indicator glows orange.	90% charged
The LED indicator glows green.	Fully charged
The LED Indicator flashes red rapidly.	Charging failed

Checking the Battery Power

You can check the current battery power by holding down the programmed **Battery Power Indicator** key preset by your dealer. And release the key to exit. Battery power indications and alert tone are listed below:

LED Indication/Tone	Battery Power
The LED Indicator glows green.	High
The LED Indicator glows orange.	Medium
The LED Indicator glows red.	Low
The LED Indicator glows red and an alert tone sounds.	The battery runs low. Please recharge or replace the battery for proper radio operation

Basic Operations

Turning the Radio On/Off

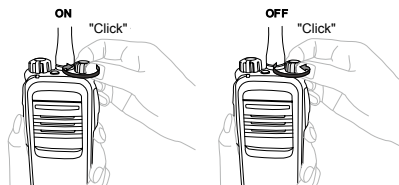

Adjusting the Volume



Selecting a Zone

A zone is a group of channels with the same property, which can facilitate convenient management over the

channels. The radio supports 3 zones, each of which consists of up to 16 channels. Your dealer can program the zone for your specific needs. You can switch to the appropriate zone by pressing the programmed **Zone Up** or **Zone Down** key preset by your dealer.

Selecting a Channel

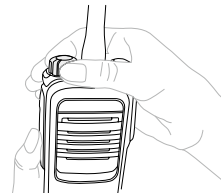

Note: If the Channel Notify feature is enabled by your dealer, the radio will announce the channel number upon channel switching.

Call Services

After the radio is powered on, you can make and receive calls. To ensure optimal volume of the receiving radio, keep the microphone about 2.5 to 5 centimeters away from your mouth when transmitting.



Private Call

Initiating a Private Call

In the standby mode, hold down the **PTT** key to initiate a private call to the private contact preset for the current channel.

You may request your dealer to preset a regular private call contact for each digital channel.

Receiving and Responding to a Private Call

When you receive a private call, you can listen to it without any operation and hold down the **PTT** key to call back within the preset time.

Group Call

Initiating a Group Call

In the standby mode, hold down the **PTT** key to initiate a group call to the group contact preset for the current channel.

Receiving and Responding to a Group Call

When you receive a group call, you can listen to it without any operation and hold down the **PTT** key to call back within the preset time.

Call on Analog Channel (No Signaling)

To transmit on an analog channel, hold down the **PTT** and speak into the microphone. To receive, release the **PTT** key.

Please refer to the Feature Description and Operation Manual along with the product for operation description on how to make and receive calls on the analog channel with signaling.

Emergency Call

In case of emergency, you can use Emergency Call to ask for help from your companion or the control center.

Emergency Call needs to be configured and enabled by your dealer. Please refer to the Feature Description and Operation Manual along with the product for details.

Available Features

Available features of this radio are listed below. Please refer to the Feature Description and Operation Manual for detailed feature descriptions.

Feature Type	Detailed Feature
Basic Setting	<ul style="list-style-type: none">• Indication: LED, Tone, Vibration• Audio: Mic AGC, Treble Boost, LQO, Audio Feedback Suppression• Scanning: Scan On, Scan Off, Scan List• Other Features: Power Level, VOX, One Touch Call, Renting, Programming, Covert Mode
Digital Features	<ul style="list-style-type: none">• Voice Services: Group Call, Private Call, All Call,• Control Services: Alert Call, Radio Check, Remote Monitor, Radio Enable, Radio Disable, Priority Interrupt, Time-out Timer (TOT)• Personal Security Services: Emergency Alarm, Man Down, Lone Worker• Encrypt• Network: Talk Around, Roam• Other Features: Pseudo Trunking

Analog Features	<ul style="list-style-type: none">• Voice Services: Call without Signaling, Call with Signaling,• Control Services: Compandor, Time-out Timer (TOT), Monitor, Squelch Off, Squelch Level Adjustment, CTCSS/CDCSS• Personal Security Services: Emergency Alarm, Man Down, Lone Worker• Scrambler• Talk Around
Accessory-related Features	<ul style="list-style-type: none">• BT
API Features	<ul style="list-style-type: none">• GPS Report• Radio Registration Service• Telemetry

Troubleshooting

Phenomena	Analysis	Solution
The radio cannot be powered on.	The battery may be improperly installed.	Remove the battery and then reattach it.
	The battery power may run out.	Recharge or replace the battery.
	The battery may suffer from poor contact caused by dirtied or damaged battery contacts.	Clean the battery contacts.
During receiving, the voice is weak, discontinuous or totally inactive.	The battery voltage may be low.	Recharge or replace the battery.
	The volume level may be low.	Increase the volume by rotating the Volume Control Knob .
	The antenna may get loose or may be improperly installed.	Turn off the radio and reattach the antenna.
	The speaker may be blocked or damaged.	Clean the surface of the speaker.
You cannot communicate with other members.	The frequency or signaling may be inconsistent with that of other members.	Set your TX/RX frequency and signaling to the same as that of other members.
	The channel type (digital and analog) may be set inconsistently.	Make sure all members are on the same digital or analog channel.
	You may be too far away from the group members.	Move towards other members.
Irrelevant communication or noise is heard on the channel.	You may be interrupted by radios using the same frequency.	Change the frequency, or adjust the squelch level.
	The radio may be set with no signaling.	Set signaling for all member radios to avoid interference at the same frequency.
The noise is too loud.	You may be too far away from other members.	Move towards other members.
	You may locate in an unfavorable position. For example, your communication may be blocked by high buildings or frustrated in the underground areas.	Move to an open and flat area, and restart the radio to try again.
	You may suffer from external disturbance (such as electromagnetic interference).	Stay away from equipment that may cause interference.

If the above solutions cannot fix your problems, or you may have some other queries, please contact us or your local dealer for more technical support.

Care and Cleaning

To guarantee optimal performance as well as a long service life of the product, please follow the tips below.

Product Care

- Do not pierce or scrape the product.
- Keep the product far away from substances that can corrode the circuit.
- Do not hold the product by its antenna or earpiece cable directly.
- Attach the accessory connector cover when the accessory is not in use.

Product Cleaning



Caution: Turn off the product and remove the battery before cleaning.

- Clean up the dust and fine particles on the product surface and charging piece with a clean and dry lint-free cloth or a brush regularly.
- Use neutral cleanser and a non-woven fabric to clean the keys, control knobs and front case after long-time use. Do not use chemical preparations such as stain removers, alcohol, sprays or oil preparations, so as to avoid surface case damage.
- Make sure the product is completely dry before use.

Optional Accessories

The following items are the main optional accessories for the product, and please consult your local dealer for more other accessories.



Caution: Use the accessories specified by the Company only. If not, the Company shall not be liable for any loss or damage arising out of use of unauthorized accessories.

Type	Model	Name
Power Supply	BL2503	Li-ion Battery(2500mAh)
	CH10A06	Dual Pocket MCU Charger Kit (for Li-ion/Ni-MH Batteries)
	CHV09	Vehicle Adapter for Charger
	MCA05	Battery Optimizing System
	MCA06	MCU Multi-unit Rapid-rate Charger
	MCA08	MCU Multi-unit Charger(Thick Battery)
Audio Accessories	ADN-01	Wireless Audio Adapter
	EAN17	3-wire Surveillance Earpiece with Transparent Acoustic Tube(Beige)
	EAN18	3-wire Surveillance Earpiece with Transparent Acoustic Tube (Black)
	EAN23	Detachable Earpiece with Transparent Acoustic Tube
	EHN16	C-Earset
	EHN17	Swivel Earset
	ESN12	Earbud
	ESW01	Wireless Earpiece
	ESW01-N1	Wireless Earset Kit
SM18N2	Remote Speaker Microphone(IP57)	
Cable	PC38	Programming Cable (USB port)
Carrying Accessories	LCBN13	Universal Chest Pack (Nylon)(Black)



致用户

非常感谢您对我们产品的青睐！本手册旨在让您快速掌握本产品的使用，如需了解产品详细功能和操作，请参阅本产品配套的《功能与操作手册》。

为了避免因不当操作而给您带来身体伤害或财产损失，请于使用本产品前详细阅读《安全信息手册》。

本手册适用于以下机型：

PD702i 数字手持终端

图标说明

 表示数字信道独有的功能，只能在数字信道上使用。

 表示模拟信道独有的功能，只能在模拟信道上使用。

未用图标区分的功能在数字信道和模拟信道上都可使用。

免责声明

本手册在编制过程中力求内容的准确性与完整性，但对于可能出现的错误或疏漏，我司不承担任何责任。由于技术的不断发展，我司保留不予通知而更改产品设计与规格的权利。未经我司事先书面授权，不得以任何形式对本手册进行复制、修改、翻译和散发。

本手册中涉及的第三方产品和内容归第三方所有，我司对其准确性、有效性、及时性、合法性或完整性均不提供保证。

如需更多信息或对本手册有任何建议，欢迎访问我们的网站：<http://www.hytera.com>，或拨打我司服务热线：400-830-7020。

射频辐射信息

本产品仅限于能够满足射频能量辐射要求的职业应用。使用者必须清楚了解射频辐射危害并可采取相应措施，满足射频辐射限定要求。

射频辐射常识

射频指可以辐射到空间的电磁频率，是通讯、医疗、食品加工等领域广泛使用的一种技术，在使用过程中会产生一定的射频辐射。

射频辐射安全

为了确保用户的身心健康，来自科学、工程、医药、健康和工业的专家们与相关组织共同研究制定了射频辐射标准和准则，如下所示：

- 美国联邦通信委员会联邦政府法规汇编第47卷第2部分J子部分。
- 美国国家标准协会 (ANSI)/电气和电子工程师协会 (IEEE) 标准C95.1-1992版。
- 电气和电子工程师协会标准C95.1-1999版。

- 国际非电离辐射防护委员会(ICNIRP)于1998年颁布的标准。

美国联邦通信委员会监管要求

按照美国联邦通信委员会的监管要求，本产品必须符合美国联邦通信委员会射频辐射限制规定，否则不能在美国市场上销售。并要求制造商可通过在产品上张贴标签的方式，告知用户应注意的事项，提高用户的防辐射意识。

射频辐射控制及操作说明

为了使产品发挥最佳性能及确保符合上述标准中有关职业或受控环境中的辐射限制要求，发送时间不得超过额定因数的50%（最高50%的时间发射），且需遵照下列说明：



- 仅在发射（讲话）时产生射频能量辐射，接收（收听）和待机时均不会产生。
- 发射时终端与身体的距离至少保持在2.5厘米以上。

欧盟指令符合性声明

本产品经独立第三方机构认证，符合欧盟指令“1999/5/EC”中的相关要求。

请注意，本声明仅适合欧盟国家。

目录

包装清单	2
熟悉本产品	2
部件介绍	2
可编程键	2
LED指示灯	2
用前准备	2
安装电池	2
安装天线	2
安装皮带夹	3
安装附件	3
充电	3
查看电量	3
基本操作	4
开机与关机	4
调节音量	4
选择区域	4
选择信道	4
呼叫	4
个呼 	4
组呼 	4
模拟信道呼叫 (无信令) 	4
紧急报警	4
功能说明	5
故障处理	5
保养与清洁	6
选购配件	6
保修范围与期限	6

包装清单

包装盒内含有以下物品。如有任何物品丢失或损坏，请与您所购产品的经销商联系。



备注：天线频段请参考天线底部色环标签内容。若标签未注明频段，则参考主机标签上的具体频段。

熟悉本产品

部件介绍

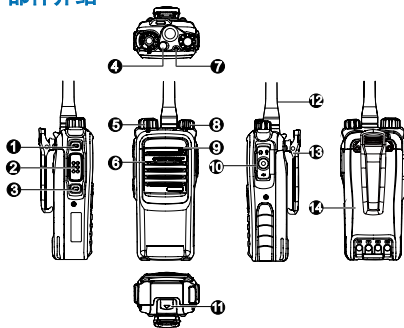

序号	部件名称	序号	部件名称
1	SK1 (侧键1)	8	电源开关/音量控制旋钮
2	PTT键 (发射按键)	9	麦克风
3	SK2 (侧键2)	10	附件接口
4	TK (顶部键)	11	电池推钮
5	信道选择旋钮	12	天线
6	扬声器	13	皮带夹
7	LED指示灯	14	电池

可编程键

为了提升操作便利性，本产品提供3个可编程键：TK (⊕)、SK1和SK2。可由您的经销商编程为功能快捷键，详情请咨询您的经销商。各功能的详细介绍您可以参考对应的“功能手册”。



注意：【TK】键出厂时设置短按为“紧急报警开启”快捷键，长按为“紧急报警关闭”快捷键。

LED指示灯

LED指示灯	产品工作状态
绿灯闪烁	正在开机
绿灯长亮	正在接收
红灯长亮	正在发送
橙灯慢闪	正在扫描或者漫游
橙灯快闪	紧急状态
橙灯长亮	橙灯长亮期间，您可以按住【PTT】键进行回呼

用前准备

安装电池

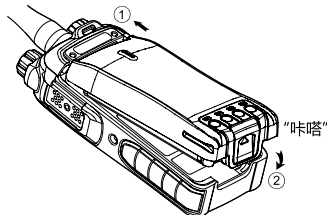

备注：如需卸下电池，请先关闭本产品，然后将底部电池推钮往上提起，并取出电池。

安装天线

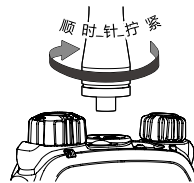

注意：请勿手持天线顶端甩动本产品，否则将降低本产品天线的工作性能和使用寿命。

安装皮带夹

步骤 1 卸下主机上的皮带夹螺钉。

步骤 2 将皮带夹的螺钉孔对准主机上的螺钉孔，然后用螺钉锁紧。

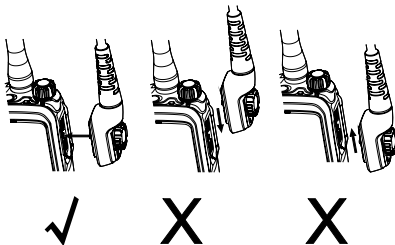
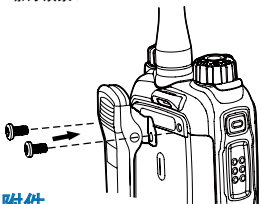

步骤 3 拧紧附件插头上的螺钉。

安装附件

步骤 1 打开附件接口盖。

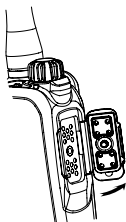

步骤 2 将附件（例如：音频附件、编程线）插头对准附件接口。

注意：对准过程中，请小心操作，避免附件接头的螺钉划花附件接口螺钉口外圈的硅胶，从而影响产品的防水性能。

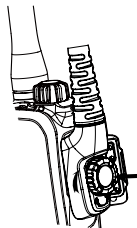

充电



注意：

- 请使用我司指定的充电座充电。
- 为整机充电时，建议先关机并提前参阅《安全信息手册》，以获取必要的电池安全信息。
- 为获得最佳电池性能，首次充电时，请至少充电5小时。

整机充电

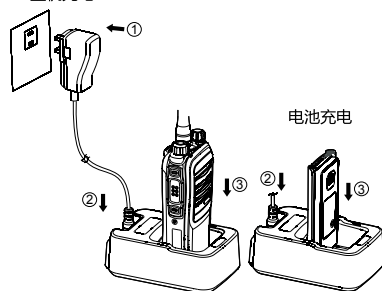

观察充电座LED指示灯可了解当前充电状态：

指示灯显示	当前充电状态
红色LED慢闪	待机（空载）
红色LED长亮	正在充电
橙色LED长亮	电池已充满90%的电量
绿色LED长亮	电池已经充满
红色LED快闪	充电过程中出现故障

查看电量

如果经销商为本产品设置了【电池电量提示】快捷键，那么您可以按住该快捷键通过LED指示灯和提示音查看电池剩余电量，松开该快捷键取消查看电池剩余电量。

LED指示灯/提示音	电池电量
LED指示灯亮绿灯	电量高
LED指示灯亮橙灯	电量中
LED指示灯亮红灯	电量低
LED指示灯亮红灯，同时伴有低音提示音	电量不足，请尽快充电或者更换电池

基本操作

开机与关机

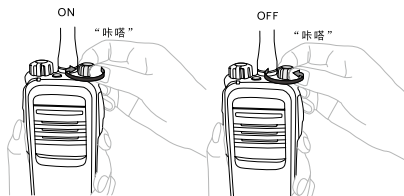

调节音量

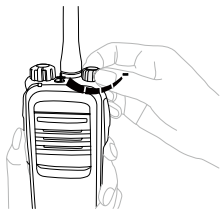

选择区域

区域是一个信道组，您可以将具有相同属性的信道列入一个区域中，这样便于您对现有信道进行有效管理。本产品支持3个区域，每个区域最多包含16个信道。若经销商为您设置了【区域上调】/【区域下调】快捷键，您可以通过按此快捷键可切换至所需区域。

选择信道

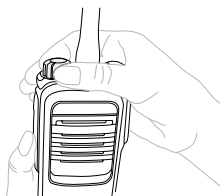

备注：如果经销商为本产品开启了信道播报功能，此处切换信道时本产品将播报信道号。

呼叫

开机成功后，您可以进行各种呼叫操作。为了保证接收方最佳接收音量，发射时请保持麦克风距离嘴大约2.5~5厘米。

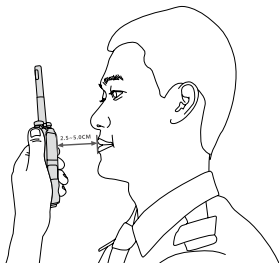

个呼

发起个呼

在待机状态下，按住【PTT】即可对当前数字信道上预设的个呼联系人发起个呼。

您可通过经销商为每个数字信道预设一个“发射联系人”，该联系人可以是个呼联系人，也可以是组呼或全呼联系人。

接听和回复个呼

接收到个呼后，您无需任何操作即可接听，在预设时间内按住【PTT】键可发送回呼。

组呼

发起组呼

在待机状态下，按住【PTT】即可对当前数字信道上预设的组呼联系人发起组呼。

接听和回复组呼

接收到组呼后，您无需任何操作即可接听，在预设时间内按住【PTT】可发送回呼。

模拟信道呼叫（无信令）

在模拟信道上，如需发射，请按住【PTT】键并对着麦克风讲话。如需接收，请松开【PTT】键。

使用信令发起呼叫的操作方法请参阅本产品配套的《功能与操作手册》。

紧急报警

遇到紧急情况时，您可通过此功能来向同伴或控制中心寻求帮助。

紧急报警功能需由经销商为您配置和开启，详情请参阅本产品配套的《功能与操作手册》。

功能说明

本机型所支持的功能如下表所示，相关功能详细描述请参考《功能与操作手册》。

功能分类	具体功能
基本设置	<ul style="list-style-type: none">提示设置：指示灯，提示音，振动音频设置：麦克风自动增益，无条件高音增强，音质音量优化器，声反馈抑制扫描设置：开启扫描，关闭扫描，设置扫描列表其他：功率级别，声控，一键呼叫，租赁，编程，隐蔽模式
数字功能	<ul style="list-style-type: none">语音业务：组呼，个呼，全呼补充业务：呼叫提示，对讲机检查，远程监听，对讲机激活，对讲机遥控，优先打断，超时禁发个人安全：紧急报警，倒放，单独工作加密网络：脱网、漫游其他：虚拟集群
模拟功能	<ul style="list-style-type: none">语音业务：无信令呼叫，有信令呼叫补充业务：压扩，超时禁发，监听，静噪打开，静噪级别调整，亚音频/亚音数码个人安全：紧急报警，倒放，单独工作扰频脱网
附件扩展	<ul style="list-style-type: none">蓝牙
API	<ul style="list-style-type: none">GPS上传对讲机注册服务遥测

故障处理

故障描述	原因分析	解决方法
无法开机	电池可能未正确安装	取出电池并重新装入。
	电池电量可能已经耗尽	充电或更换电池。
	电池触点污浊或受损而导致接触不良	清洁电池触点。
接收信号时声音小、断续或无声	电池电压过低	充电或更换电池。
	音量较小	通过【音量控制】旋钮调大音量。
	天线松动或安装不到位	关机后重新安装天线
	扬声器堵塞或受损	进行简单的外部清洁
无法与组内其他成员通话	所用频率或信令设置与组内其他成员不同	设置与组内其他成员相同的频率和信令。
	数字、模拟信道设置不当	设置相同的数字信道或模拟信道。
	距离组内其他成员太远	尽量靠近其他成员。
信道中出现其他通话声或杂音	受到同频用户的干扰	更改为新的频点，或调整静噪级别
	未设置信令	对组内所有对讲机进行信令设置，以防止同频干扰。但必须同时更改组内所有手持终端的信令设置
噪声较大	与其他成员之间的通讯距离过远	靠近其他成员。
	所处位置不佳，如受高大建筑物阻挡，或位于地下室等	移至开阔平坦地后，开机重试。
	受外界环境或电磁干扰	避开可能引起干扰的设备。

如上述方法仍未解决您的问题，或您遇到一些其他的故障，请联系当地经销商或我司以获取更多的技术支持。

保养与清洁

为了保证本产品发挥其良好性能，以及延长其使用寿命，请熟悉以下内容，以便更好地对本产品进行日常保养与清洁。

保养

- 请勿用硬物穿刺或刮花本产品。
- 请勿将本产品存放于含有腐蚀电子电路物质的环境。
- 携带或使用本产品过程中，请勿用手提天线或耳机线。
- 当不使用附件时，请盖好附件接口盖。

清洁



注意：在您进行清洁之前，请关机并取出电池。

- 请定期使用洁净干燥的无绒布或毛刷拭去本产品表面及充电极片附着的粉尘。
- 本产品的按键、控制旋钮和机壳极易变脏。可用中性洗涤剂和无纺布对其进行清洁，请勿用去污剂、酒精、喷雾剂或石油制剂等化学药剂进行清洁，以避免产品表面和外壳受损。
- 清洁之后，务必保证本产品彻底干燥，否则请勿使用。

选购配件

本产品主要的选购附件已包含在如下列表中，如需更多附件信息，请咨询您当地的经销商或拨打我司服务热线400-830-7020。



注意：请使用我司指定的配件。若擅自使用未经许可的配件，则由此所导致的一切后果，由用户自行负责。

配件类型	配件型号	配件名称
电源类	BL2503	电池 2500mAh (锂/镍氢) 电池MCU双插槽充电座套件 (含开关电源)
	CH10A06	座充车载电源适配器
	CHV09	电池分析仪
	MCA05	锂电/镍电MCU快速排充 (兼容薄电和厚电)
	MCA06	锂电/镍电MCU快速排充 (兼容薄电和厚电)
	MCA08	无线适配器
音频类	ADN-01	三线透明管监控耳机 (米色)
	EAN17	三线透明管监控耳机 (黑色)
	EAN18	分体式透明管耳机
	EHN16	分体C型耳挂式耳机
	EHN17	分体可调节耳挂式耳机
	ESN12	分体式耳塞式耳机
	ESW01	无线耳机
	ESW01-N1	无线耳机套件
	SM18N2	防水扬声器话筒 (IP57)
	线材类	PC38
携带类	LCBN13	手持终端通用尼龙胸包

保修范围与期限

我司承诺，凡我司生产的产品，自购买之日起，在正常使用、操作与维护条件下，出现材料或制造工艺方面的缺陷，可享受以下规定的保修服务。

主机 24个月

标配附件 (包括电池、充电座) 12个月



Preface

Thanks for your favor in our product. This manual is helpful for you to quickly know how to use the product. For detailed features and operations, please refer to the Feature Description and Operation Manual along with the product.

To avoid body injury or property loss caused by misoperation, please read the Safety Information Booklet carefully before use.

This manual is applicable to the following product:

PD702i Digital Trunking Portable Radio.

Disclaimer

Hytera Communications Corporation Limited (the Company) endeavors to achieve the accuracy and completeness of this manual, but no warranty of accuracy or reliability is given. All the specifications and designs are subject to change without notice due to continuous technology development. No part of this manual may be copied, modified, translated, or distributed in any manner without the express written permission of us.

We do not guarantee, for any particular purpose, the accuracy, validity, timeliness, legitimacy or completeness of the Third Party products and contents involved in this manual.

If you have any suggestions or would like to learn more details, please visit our website at: <http://www.hytera.com>.

RF Radiation Information

This product must be restricted to operations in an occupational/controlled RF exposure environment. Users must be fully aware of the hazards of the exposure and able to exercise control over their RF exposure to qualify for the higher exposure limits.

RF Radiation Profile

Radio Frequency (RF) is a frequency of electromagnetic radiation in the range at which radio signals are transmitted. RF technology is widely used in communication, medicine, food processing and other fields. It may generate radiation during use.

RF Radiation Safety

In order to ensure user health, experts from relevant industries including science, engineering, medicine and health work with international organizations to develop standards for safe exposure to RF radiation. These standards consist of:

- United States Federal Communications Commission,

Code of Federal Regulations; 47CFR part 2 sub-part J;

- American National Standards Institute (ANSI)/ Institute of Electrical and Electronic Engineers (IEEE) C95. 1-1992;
- Institute of Electrical and Electronic Engineers (IEEE) C95.1-1999;
- International Commission on Non-Ionizing Radiation Protection (ICNIRP) 1998;

FCC Regulations

Federal Communication Commission (FCC) requires that all radio communication products should meet the requirements set forth in the above standards before they can be marketed in the U.S, and the manufacturer shall post a RF label on the product to inform users of operational instructions, so as to enhance their occupational health against exposure to RF energy.

Operational Instructions and Training Guidelines

To ensure optimal performance and compliance with the occupational/controlled environment RF energy exposure limits in the above standards and guidelines, users should transmit not more than 50% of the time and always adhere to the following procedures:

- RF energy will be generated only when the radio is transmitting.
- The radio must be at least 2.5 centimeters away from human body when transmitting.

EU Regulatory Conformance

As certified by the qualified laboratory, the product is in compliance with the essential requirements and other relevant provisions of the Directive 1999/5/EC.

Please note that the above information is applicable to EU countries only.

Contents

Items in the Package	2
Product Overview	2
Product Controls	2
Programmable Keys	2
LED Indicator	2
Before Use	3
Attaching the Battery	3
Attaching the Antenna	3
Attaching the Belt Clip	3
Attaching the Accessories	3
Charging the Battery	3
Checking the Battery Power	4
Basic Operations	4
Turning the Radio On/Off	4
Initial Registration	4
Adjusting the Volume	4
Selecting a Group Contact	4
Call Services	4
Private Call	4
Group Call	5
Emergency Call	5
Available Features	6
Troubleshooting	7
Care and Cleaning	8
Optional Accessories	8

Items in the Package

Please unpack carefully and check if all items listed below are received. If any item is missing or damaged, please contact your dealer.

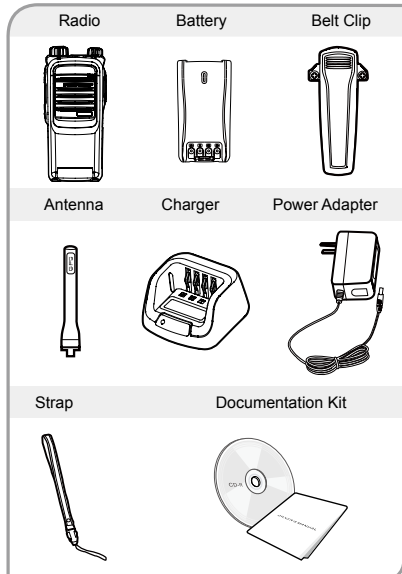

Note: The frequency band is marked on the label of antenna; if not, please refer to the label on the radio for frequency band information.

Product Overview

Product Controls

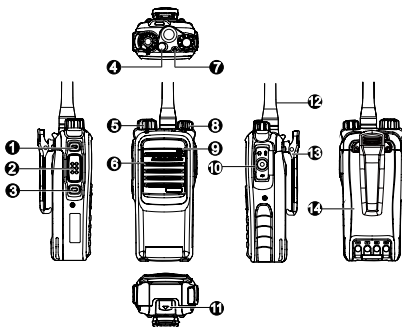

No.	Part Name	No.	Part Name
1	SK1 (Side Key 1)	8	Power On-Off/Volume Control Knob
2	PTT (Push-to-Talk) Key	9	Microphone
3	SK2 (Side Key 2)	10	Accessory Connector
4	TK (Top Key)	11	Battery Latch
5	Group Call Selector knob	12	Antenna
6	Speaker	13	Belt Clip
7	LED Indicator	14	Battery

Programmable Keys

For enhanced convenience, you may request your dealer to program the **SK1**, **SK2**, and **TK** (⚠) as shortcuts to certain functions. Please refer to the Feature Description and Operation Manual along with the product for more details.



Caution: The **TK** key is programmed with emergency feature by default (short press: Emergency On; long press: Emergency Off). It is programmable by your dealer.

LED Indicator

LED Indication	Radio Status
The LED indicator flashes green.	Powering on
The LED indicator flashes green slowly.	Standby
The LED indicator glows green.	Receiving
The LED indicator glows red.	Transmitting
The LED indicator flashes red.	Establishing a call (the LED indicator on the calling radio flashes)
The LED indicator flashes orange rapidly.	Establishing a Full Off Air Call Set-Up (FOACSU) (the LED indicator on the called radio flashes)
The LED indicator flashes orange slowly.	Hunting
The LED indicator glows orange.	Call hung period. No voice is being transmitted or received on the traffic channel during a call. Within such period, you can hold down the PTT key to talk to the other party.

Before Use

Attaching the Battery

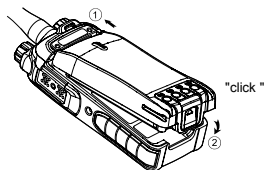

Note: To remove the battery, turn off the radio first, and then slide the battery latch upwards to unlock the battery.

Attaching the Antenna

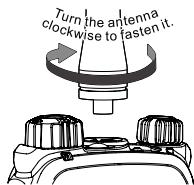

Caution: Do not hold the radio by its antenna, otherwise the performance and lifespan of the antenna will be reduced.

Attaching the Belt Clip

Step 1 Remove the screws.

Step 2 Align the screw holes on the belt clip with those on the radio's back, and then tighten the screws.

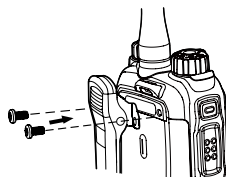
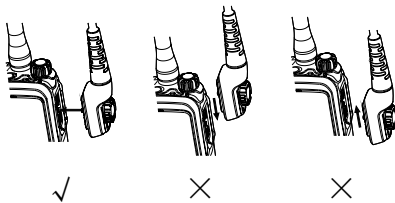

Attaching the Accessories

Step 1 Open the accessory connector cover as shown below.



Step 2 Align the accessory (such as an audio accessory, or a programming cable) plug with the accessory connector.



Caution: Do not scrape the silicone rubber surrounding the accessory connector screw hole, in order to ensure the waterproof performance of the radio.

Step 3 Tighten the screw on the plug.

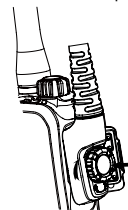

Charging the Battery



Caution

- Use the charger specified by the Company to charge the battery.
- Make sure the radio is powered off before charging. Read the Safety Information Booklet in advance to get necessary safety information.
- Charge a new battery for at least 5 hours before initial use for best performance.

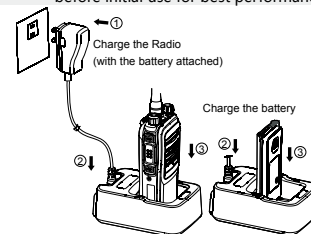

Charging Status Indication (on charger):

LED Indication	Charging Status
The LED Indicator flashes red slowly.	Standby (no load)
The LED Indicator glows red.	Charging
The LED indicator glows orange.	90% charged
The LED indicator glows green.	Fully charged
The LED Indicator flashes red rapidly.	Charging failed

Checking the Battery Power

You can check the current battery power by holding down the programmed **Battery Power Indicator** key preset by your dealer. And release the key to exit. Battery power indications and alert tone are listed below:

LED Indication/Tone	Battery Power
The LED Indicator glows green.	High
The LED Indicator glows orange.	Medium
The LED Indicator glows red.	Low
The LED Indicator glows red and an alert tone sounds.	The battery runs low. Please recharge or replace the battery for proper radio operation

Basic Operations

Turning the Radio On/Off

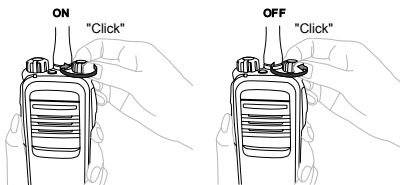

Initial Registration

Before the radio can make the communication normally, it needs to register in the system. Once you turn on the radio, it will start hunting the control channels for available base station and attempt to make the registration automatically.

Hunting the Control Channel

The radio starts hunting the control channel for available

base station automatically upon power-on. During hunting, the LED indicator flashes orange slowly. There are two hunt plans: Fixed Control Channel and Flexible Control Channel. You may request your dealer to set the appropriate plan for your radio. Please refer to the Feature Description and Operation Manual along with the product for details.

Registering

When the radio searches for a control channel, the radio determines whether the base station allows it to register. Upon successful registration, the radio is ready for communication. If you want the radio to register with another base station, press the programmed **Manual Current Hunt** key to hunt again.

 **Note:** For smooth registration, it is highly recommended to put the frequently used frequencies of base stations in the control channel list via the dealer.

Adjusting the Volume

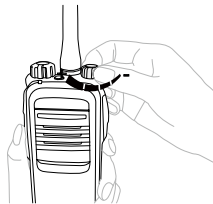

Selecting a Group Contact

After the radio is registered successfully after power-on, you can select a group contact through any of the following methods:

- Knob: Rotate the **Group Call Selector Knob** to select an appropriate group contact. An audio alert will be given in case of no group contact preset for this knob.
- Shortcut key: If the dealer predefines the

programmed **Group Up** and **Group Down** keys, you can select the group contact in an ascending way or descending way by using the keys accordingly.

Call Services

After the radio is powered on and registered, you can make and receive calls. To ensure an optimal volume of the receiving radio, keep the microphone about 2.5 to 5 centimeters away from your mouth when transmitting.



Note: If the radio does not register successfully or you select an empty group by rotating the **Group Call Selector Knob**, the radio cannot initiate any call.

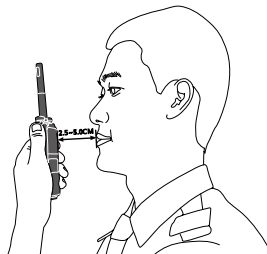

Private Call

Private call is a call made to a private contact. There are two ways to answer the private call: Full Off Air Call Set-Up (FOACSU) and Off Air Call Set-Up (OACSU). The specific way is decided by the settings made for the called radio via the network management application.

- FOACSU: The called party needs to answer the call manually.
- OACSU: The called party answers the call without any operation.

Initiating a Private Call

You can make a private call through any of the following ways:

- Press the programmed **Redial** key to call the last person you have contacted, or press the programmed **BackDial** key to call the last person who has contacted you.
- If your dealer selects a private contact for the One Touch Call/Menu feature, you can press the programmed **One Touch Call/Menu** key to initiate a private call to the preset contact.

Receiving a Private Call

- FOACSU

When you receive a private call, you can hold down the **PTT** key within the preset time period to answer the call. After the call is established successfully, the radio will emit a tone.

- OACSU

When you receive a private call, the radio will establish the call automatically.

Voice Communication

After a private call is established, either the calling party or called party can hold down the **PTT** key to talk when the talk right is free.

Ending a Private Call

The call will be terminated when any of the following situations occurs:

- Neither party holds down the **PTT** key to speak before the preset time period expires.
- The call duration exceeds the time preset by the dealer.
- Either of the parties ends the ongoing call.
- The base station signal is lost.
- Either of the parties selects an empty group via the **Group Call Selector Knob** during the call.
- A pre-emptive call or an emergency call occupies the channel.

Group Call

The Group Call includes group call and broadcast call. In a group call, both the calling party and the called party can talk. However, in a broadcast call, only the calling party can talk while the called party can listen to it only. The radio cannot make a broadcast call unless the dealer authorizes it.

As a broadcast call is made in the same manner as a group call, we will only detail their differences in the following introductions.

Initiating a Group Call

You can make a group call through any of the following ways:

- If your dealer selects a group contact for the **One Touch Call/Menu** feature, you can press the programmed One Touch Call/Menu key to initiate a group call to the preset contact.
- Rotate the **Group Call Selector Knob** to select the appropriate contact, and then hold down the **PTT** key to initiate a group call.

Receiving a Group Call

You can answer a group call without any operation after this call is established successfully and the radio will emit a tone.

Late Entry

With the Late Entry feature, a group member that has missed the start of a group call can join this active group call later without any operation.

The Late Entry feature is applicable to the following situations:

- The radio moves within the coverage area after the group call is established.
- The radio is turned on after the group call is established.
- The radio is busy with other call services when the group call is established. After such other call

services end, the radio will join this group call.

- The signal of the base station recovers after the group call is established.
- The radio is added to the group after the group call is established.

Voice Communication

- Group call: After a group call is established, either of the calling or called party can hold down the **PTT** key to talk when talk right is free.
- Broadcast call: After the call is established, only the calling party can talk by holding down the **PTT** key.

Ending a Group Call

The call will be terminated when any of the following situations occurs:

- No group member holds down the **PTT** key to talk before the preset time period expires (except in the broadcast call).
- The call duration exceeds the time preset by the dealer.
- The calling party ends the in-progress call (if the called party ends the call, he/she will exit this group call but can rejoin via Late Entry feature).
- The base station signal is lost.
- A pre-emptive call or an emergency call occupies the channel.

Emergency Call

In case of emergency, you can use Emergency Call to ask for help from your companion or the control center.

Emergency Call needs to be configured and enabled by your dealer. Please refer to the Feature Description and Operation Manual along with the product for details.

Available Features

Available features of this radio are listed below. Please refer to the Feature Description and Operation Manual for detailed feature descriptions.

Feature Type	Detailed Feature
Basic Setting	<ul style="list-style-type: none"> ● Indication: Vibration, LED, Tone ● Audio: Mic AGC, Treble Boost, LQO, Audio Feedback Suppression ● Operation Mode Switch ● Other Features: Power Level, VOX, Covert Mode, One Touch Call, Renting
Mobility management	<ul style="list-style-type: none"> ● Hunt ● Roam
Voice Services	<ul style="list-style-type: none"> ● Group Call ● Private Call ● PSTN/PABX Call ● Broadcast Group Call ● All Call ● Priority ● Call Queue ● Time-out Timer (TOT)
Control Services	<ul style="list-style-type: none"> ● Over the Air Programming (OTAP) ● Ambience Listening ● Interrupt ● Override ● Emergency Alarm
Personal Security Services	<ul style="list-style-type: none"> ● Man Down ● Lone Worker

Feature Type	Detailed Feature
Communication Security Services	<ul style="list-style-type: none"> ● Authentication ● Encrypt ● Stun ● Revive ● Kill

Troubleshooting

Phenomena	Analysis	Solution
The radio cannot be powered on.	The battery may be improperly installed.	Remove the battery and then reattach it.
	The battery power may run out.	Recharge or replace the battery.
	The battery may suffer from poor contact caused by dirtied or damaged battery contacts.	Clean the battery contacts.
The radio cannot make a registration.	The radio may not detect signals from the base station.	Make sure the radio is within the coverage of the base station.
	The radio may be unauthorized.	Contact the base station manager to check whether the radio is authorized in the network management system.
The radio registers repeatedly.	The signal may be discontinuous.	Make sure the radio is within the coverage of the base station.
The radio cannot establish a call.	The signal may be poor.	Make sure the radio is within the coverage of the base station.
No voice is heard after a call is established.	The radio ID may be repeated.	Contact the base station manager to check whether the radio ID is repeated in the network management system.
The called party disconnects repeatedly during communication.	The signal may be discontinuous.	Make sure the radio is within the coverage of the base station.
During receiving, the voice is weak, discontinuous or totally inactive.	The battery power may be low.	Recharge or replace the battery.
	The volume level may be low.	Increase the volume by rotating the Power On-Off/Volume Control Knob clockwise, or request your dealer to disable the Digital MIC AGC feature.
	The antenna may get loose or may be improperly installed.	Turn off the radio and reattach the antenna.
	The speaker may be blocked or damaged.	Clean the surface of the speaker.
You cannot communicate with other members.	The signal may be poor.	Make sure you and the talk party(ies) are within the communication range.
The voice is unclear.	The signal may be poor.	Make sure you and the talk party(ies) are within the communication range.
The noise is too loud.	The signal may be poor.	Make sure you and the talk party(ies) are within the communication range.
	You may locate in an unfavorable position. For example, your communication may be blocked by high buildings or frustrated in the underground areas.	Move to an open and flat area, and restart the radio to try again.
	You may suffer from external disturbance (such as electromagnetic interference).	Stay away from equipment that may cause interference.

If the above solutions cannot fix your problems, or you may have some other queries, please contact us or your local dealer for more technical support.

Care and Cleaning

To guarantee optimal performance as well as a long service life of the product, please follow the tips below.

Product Care

- Do not pierce or scrape the product.
- Keep the product far away from substances that can corrode the circuit.
- Do not hold the product by its antenna or earpiece cable directly.
- Attach the accessory connector cover when the accessory is not in use.

Product Cleaning



Caution: Turn off the product and remove the battery before cleaning.

- Clean up the dust and fine particles on the product surface and charging piece with a clean and dry lint-free cloth or a brush regularly.
- Use neutral cleanser and a non-woven fabric to clean the keys, control knobs and front case after long-time use. Do not use chemical preparations such as stain removers, alcohol, sprays or oil preparations, so as to avoid surface case damage.
- Make sure the product is completely dry before use.

Optional Accessories

The following items are the main optional accessories for the product, and please consult your local dealer for more other accessories.



Caution: Use the accessories specified by the Company only. If not, the Company shall not be liable for any losses or damages arising out of use of unauthorized accessories.

Type	Model	Name
Power Supply	BL2503	Li-ion Battery(2500mAh)
	CH10A06	Dual Pocket MCU Charger Kit (for Li-ion/Ni-MH Batteries)
	CHV09	Vehicle Adapter for Charger
	MCA05	Battery Optimizing System
	MCA06	MCU Multi-unit Rapid-rate Charger
	MCA08	MCU Multi-unit Charger(Thick Battery)
Audio Accessories	ADN-01	Wireless Audio Adapter
	EAN17	3-wire Surveillance Earpiece with Transparent Acoustic Tube(Beige)
	EAN18	3-wire Surveillance Earpiece with Transparent Acoustic Tube (Black)
	EAN23	Detachable Earpiece with Transparent Acoustic Tube
	EHN16	C-Earset
	EHN17	Swivel Earset
	ESN12	Earbud
	ESW01	Wireless Earpiece
	ESW01-N1	Wireless Earset Kit
	SM18N2	Remote Speaker Microphone(IP57)

Type	Model	Name
Cable	PC38	Programming Cable (USB port)
Carrying Accessories	LCCBN13	Universal Chest Pack (Nylon)(Black)



致用户

非常感谢您对我们产品的青睐！本手册旨在让您快速掌握本产品的使用，如需了解产品详细功能和操作，请参阅本产品配套的《功能与操作手册》。

为了避免因不当操作而给您带来身体伤害或财产损失，请于使用本产品前仔细阅读《安全信息手册》。

本手册适用于以下机型：

PD702i 数字集群手持终端

免责声明

本手册在编制过程中力求内容的准确性与完整性，但对于可能出现的错误或疏漏，我司不承担任何责任。由于技术的不断发展，我司保留不予通知而更改产品设计与规格的权利。未经我司事先书面授权，不得以任何形式对本手册进行复制、修改、翻译和散发。

本手册中涉及的第三方产品和内容归第三方所有，我司对其准确性、有效性、及时性、合法性或完整性均不提供保证。

如需更多信息或对本手册有任何建议，欢迎访问我们的网站：<http://www.hytera.com>，或拨打我司服务热线：400-830-7020。

射频辐射信息

本产品仅限于能够满足射频能量辐射要求的职业应用。使用者必须清楚了解射频辐射危害并可采取相应措施，满足射频辐射限定要求。

射频辐射常识

射频指可以辐射到空间的电磁频率，是通讯、医疗、食品加工等领域广泛使用的一种技术，在使用过程中会产生一定的射频辐射。

射频辐射安全

为了确保用户的身心健康，来自科学、工程、医药、健康和工业的专家们与相关组织共同研究制定了射频辐射标准和准则，如下所示：

- 美国联邦通信委员会联邦政府法规汇编第47卷第2部分J子部分。
- 美国国家标准协会 (ANSI)/电气和电子工程师协会 (IEEE) 标准C95.1-1992版。
- 电气和电子工程师协会标准C95.1-1999版。
- 国际非电离辐射防护委员会(ICNIRP)于1998年颁布的标准。

美国联邦通信委员会监管要求

按照美国联邦通信委员会的监管要求，本产品必须符合美国联邦通信委员会射频辐射限制规定，否则不能在美

国市场上销售。并要求制造商可通过在产品上张贴标签的方式，告知用户应注意的事项，提高用户的防辐射意识。

射频辐射控制及操作说明

为了使产品发挥最佳性能及确保符合上述标准中有关职业或受控环境中的辐射限制要求，发送时间不得超过额定因数的50%（最高50%的时间发射），且需遵照下列说明：

- 仅在发射（讲话）时产生射频能量辐射，接收（收听）和待机时均不会产生。
- 发射时终端与身体的距离至少保持在2.5厘米以上。

欧盟指令符合性声明

本产品经独立第三方机构认证，符合欧盟指令“1999/5/EC”中的相关要求。

请注意，本声明仅适合欧盟国家。

目录

包装清单	2
熟悉本产品	2
部件介绍	2
可编程键	2
LED指示灯	2
用前准备	2
安装电池	2
安装天线	2
安装皮带夹	3
安装附件	3
充电	3
查看电量	3
基本操作	3
开机与关机	3
初次登记	4
调节音量	4
选择组呼联系人	4
呼叫	4
个呼	4
组呼	4
紧急呼叫	5
功能说明	5
故障处理	6
保养与清洁	6
选购配件	6
保修范围与期限	7

包装清单

包装盒内含有以下物品。如有任何物品丢失或损坏，请与您所购产品的经销商联系。



备注：天线频段请参考天线底部色环标签内容。若标签未注明频段，则参考主机标签上的具体频段。

熟悉本产品

部件介绍

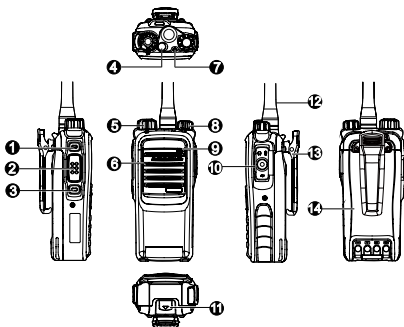

编号	部件名称	编号	部件名称
1	SK1键（侧键1）	8	电源开关/音量控制旋钮
2	PTT键（发射键）	9	麦克风
3	SK2键（侧键2）	10	附件接口
4	TK键（顶部键）	11	电池推钮
5	组呼选择旋钮	12	天线
6	扬声器	13	皮带夹
7	LED指示灯	14	电池

可编程键

为了提升操作便利性，本机的3个可编程键：SK1、SK2、TK (▲)，可由经销商编程为功能快捷键，详情请咨询您的经销商。各功能的详细介绍，您可以参考本产品对应的“功能手册”。



注意：【TK】键出厂时设置短按为“紧急报警开启”快捷键，长按为“紧急报警关闭”快捷键。您可通过经销商设置为其他功能快捷键。

LED指示灯

LED指示灯	产品工作状态
绿灯闪烁	正在开机。
绿灯慢闪	正常待机。
绿灯长亮	正在接收。
红灯长亮	正在发射。
红灯闪烁	正在建立呼叫（主叫方显示）。
橙灯快闪	正在建立手动摘机个呼（被叫方显示）
橙灯慢闪	正在扫描。
橙灯长亮	呼叫保持状态，即呼叫成功建立后，各方均处于接收状态，信道资源空闲，此时您可以按住【PTT】键讲话。

用前准备

安装电池

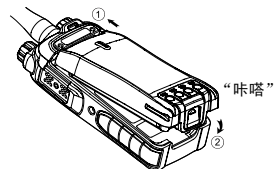

备注：如需卸下电池，请先关机，然后将底部电池推钮往上提起，并取出电池。

安装天线

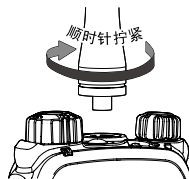



注意：请勿手持天线顶端用动本产品，否则会降低本产品天线的工作性能和使用寿命。

安装皮带夹

1. 卸下主机上的皮带夹螺钉。
2. 将皮带夹的螺钉孔对准主机上的螺钉孔，然后用螺钉锁紧。

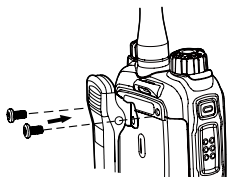

安装附件

1. 打开附件接口盖。



2. 将附件（如音频附件或者编程线等）插头对准附件接口。



注意：请小心操作，避免划伤附件接口螺钉口外圈的硅胶，以免影响产品的防水性能。

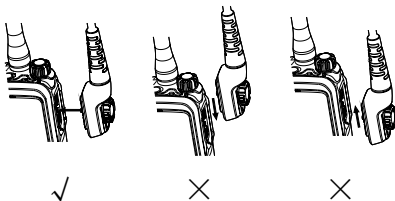

3. 拧紧附件插头上的螺钉。

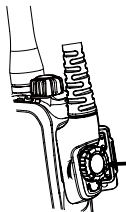

充电



注意：

- 请使用我司指定的充电座充电。
- 为整机充电时，建议先关机并提前参阅《安全信息手册》，以获取必要的电池安全信息。
- 为获得最佳电池性能，首次充电时，请至少充电5小时。

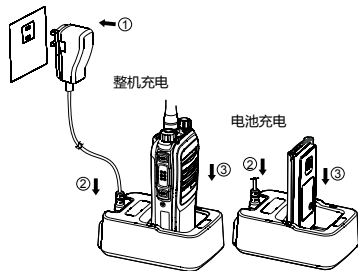

观察充电座LED指示灯可了解当前充电状态：

指示灯显示	当前充电状态
红色闪烁	待机（空载）
红色长亮	正在充电
橙色长亮	已充电90%
绿色长亮	已充满
红色快闪	充电故障

查看电量

如果经销商为本产品设置了【电池电量提示】快捷键，那么您可以按住该快捷键通过LED指示灯和提示音查看电池剩余电量，松开该快捷键取消查看电池剩余电量。

LED指示灯/提示音	电池电量
LED指示灯亮绿灯	电量高
LED指示灯亮橙灯	电量中
LED指示灯亮红灯	电量低
LED指示灯亮红灯，同时伴有低电提示音	电量不足，请尽快充电或者更换电池

基本操作

开机与关机

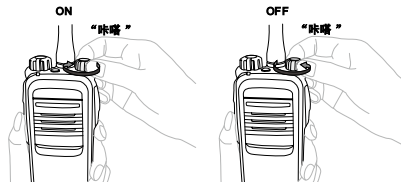

初次登记

为保证本产品的正常使用，开机后本产品将自动选择合适的基站上网登记。

扫描控制信道

本产品到基站登记时，需要先扫描控制信道以搜索可进行登记的集群系统基站。

开机后自动开始扫描。扫描时，LED指示灯红灯慢闪。扫描控制信道所采用的方式有固定控制信道和灵活控制信道两种，详情请参阅本产品配套的《功能与操作手册》。您需要通过经销商配置本产品采用的扫描方式。

登记

扫描到基站信号时，判断该基站是否允许本产品上网登记。登记成功后，您可以进行通信。如果您想选择其他的基站进行登记，可按【手动执行扫描】快捷键重新扫描。

 **备注：**为保证登记顺畅，请通过经销商将常用的基站频点写入扫描控制信道列表。

调节音量

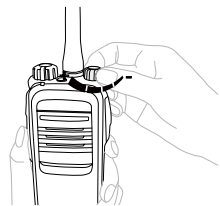

选择组呼联系人

开机登记成功后，您可以通过以下方式选择组呼联系人：

- 旋钮：旋转【组呼选择】旋钮选择所需的组呼联系人。当旋钮没有对应的组呼联系人时，本产品将发出提示音，提示您当前选择的为空组。

- 快捷键：如果经销商已为您配置【组上调】或者【组下调】快捷键，那么您可以通过此快捷键按照递增或者递减方式切换组群中的组呼。

呼叫

开机登记成功后，您可以进行各种呼叫操作。为保证接收音量最佳，发射时请保持麦克风与嘴的距离为2.5—5厘米。

 **备注：**当本产品未登记或【组呼选择】旋钮选择“空组”时，不能发起呼叫。



个呼

个呼是指对某个个呼联系人发起的呼叫。个呼接听方式分为：手动摘机呼叫（FOACSU）和自动摘机呼叫（OACSU），接听方式由集群系统设置。

- 手动摘机呼叫（FOACSU）：被叫方需要手动接听建立呼叫。
- 自动摘机呼叫（OACSU）：被叫方接收到呼叫后自动建立呼叫。

发起个呼

您可以通过以下方式发起个呼。

- 通过按【重拨】快捷键或者【回拨】快捷键，呼叫最近的呼出或者呼入联系人。
- 当经销商为您配置【一键呼叫/菜单】快捷键的呼叫对

象为“个呼联系人”时，您也可以通过【一键呼叫/菜单】快捷键发起个呼。

接听个呼

- 手动摘机呼叫（FOACSU）

接收到个呼时，如果您在预设时间内按【PTT】键，将建立呼叫。呼叫建立成功后，本产品将发出提示音。

- 自动摘机呼叫（OACSU）
接收到个呼时，本产品自动建立呼叫。

语音通信

个呼建立后，主叫和被叫都可以在【PTT】空闲时按住【PTT】键进行讲话。

结束通信

当出现以下任一情况时，语音通信将结束：

- 双方无人按【PTT】键讲话，超过预设时间。
- 通话总时间超过预设时间（该时间可由经销商配置）。
- 通话过程中，主叫或被叫的任意一方挂机。
- 基站信号丢失。
- 主叫或被叫【组呼选择】旋钮指向空组。
- 预占呼叫或紧急呼叫抢占了本通话的业务信道。

组呼

组呼分为普通组呼和广播组呼。普通组呼中，主叫和被叫均可以发射语音，而广播组呼中，仅主叫可以发射语音，被叫只能接收语音。当经销商为您开启广播组呼权限时，您才能发起广播组呼。此处仅介绍普通组呼。

两种组呼的操作方法大部分相同，下文仅在差异处进行区分。

发起组呼

您可以通过以下方式发起组呼。

- 当经销商为您配置【一键呼叫/菜单】的呼叫对象为“组呼联系人”时，您也可以通过【一键呼叫/菜单】快捷键对当前组呼联系人发起呼叫。

- 通过旋转【组呼选择旋钮】选择所需的组呼联系人，按住【PTT】即可对当前组呼联系人发起呼叫。

接听组呼

接收到组呼后，本产品将自动建立呼叫。建立呼叫成功后，同时发出提示音。

迟后进入

组呼建立后，在通话过程中允许未能加入该组呼的成员加入该呼叫。该成员不需要执行任何操作，可自动加入该呼叫。

本功能常用于以下情况：

- 组呼发起时被叫未在通话组工作范围内，在通话过程中进入到通话组工作范围。
- 组呼发起时，被叫未开机，通话过程中被叫开机了。
- 组呼A发起时，被叫正参与其他个呼B或组呼C，结束该呼叫（B或C）后，A通话还在进行。
- 组呼发起时，被叫所在位置基站信号弱或受到无线干扰，通话过程中被叫所在位置信号好转。
- 组呼发起后，新加入该组的成员。

语音通信

- 普通组呼：组呼建立后，主叫和被叫都可以在PTT空闲时按住【PTT】键进行讲话。
- 广播组呼：组呼建立后，仅主叫方可以按住【PTT】键进行讲话。被叫方仅能接收语音。

结束通信

当出现以下情况时，语音通信将结束。

- 双方无人按【PTT】讲话，超过预设时间。（广播组呼除外）
- 通话总时间超过预设时间（该时间可由经销商配置）。
- 通话过程中，主叫挂机（被叫挂机仅自身退出组呼通信，通过“迟后进入”可以重新加入该呼叫）。
- 基站信号丢失。
- 预占呼叫或紧急抢占了本通话的业务信道。

紧急呼叫

遇到紧急情况时，您可通过此功能来向同伴或控制中心寻求帮助。

紧急呼叫功能需由经销商为您配置和开启，详情请参阅本产品配套的《功能与操作手册》。

功能说明

本机型所支持的功能如下表所示，相关功能详细描述请参考《功能与操作手册》。

功能分类	具体功能
个人安全	<ul style="list-style-type: none"> ● 紧急报警 ● 倒放
通信安全	<ul style="list-style-type: none"> ● 单独工作 ● 鉴权 ● 加密 ● 遥晕 ● 复活 ● 遥毙

功能分类	具体功能
基本设置	<ul style="list-style-type: none"> ● 提示设置：指示灯，提示音，振动 ● 音频设置：麦克风自动增益，无条件高音增强，音质音量优化器，声反馈抑制 ● 模式切换 ● 其他：功率级别，声控，隐蔽模式，一键呼叫，租赁
移动管理	<ul style="list-style-type: none"> ● 扫描 ● 漫游 ● 组呼
语音业务	<ul style="list-style-type: none"> ● 个呼 ● PSTN/PABX呼叫 ● 广播呼叫 ● 全呼 ● 呼叫优先级 ● 呼叫排队 ● 超时禁发 ● 空口写频
补充业务	<ul style="list-style-type: none"> ● 环境侦听 ● 强插 ● 强拆

故障处理

故障描述	原因分析	解决方法
无法开机	电池可能未正确安装	取出电池并重新装入
	电池电量可能已经耗尽	充电或更换电池
	电池触点污浊或受损而导致接触不良	清洁电池触点
无法登记	不能检测到基站信号	确保本产品在基站的有效信号范围内
	不是基站的合法用户，不能进行登记	联系基站负责人，确认本产品是否为基站网管系统的合法用户
反复登记	信号时断时续	确保本产品在基站的有效信号范围内
不能建立呼叫	通讯信号质量差	确保本产品在基站的有效信号范围内
呼叫建立后没有声音	终端ID可能重复	联系基站负责人，确认网管系统中终端ID是否重复
呼叫中呼叫反复下线	信号时断时续，下线又迟后进入呼叫	确保本产品在基站的有效信号范围内
接收信号时声音小、断续或无声	电池电量过低	充电或更换电池
	音量较小	通过【电源开关/音量控制】旋钮增大音量或者联系经销商关闭数字麦克风风自动增益功能
	天线松动或安装不到位 扬声器堵塞或受损	关机后取下天线并重新装上，再开机 进行简单的外部清洁
无法与组内其他成员通话	通讯信号质量差	确保通话成员在有效通讯范围内
话音不清晰	通讯信号质量差	确保通话成员在有效通讯范围内
噪声较大	通讯信号质量差	确保通话成员在有效通讯范围内
	所处位置不佳，如受高大建筑物阻挡，或位于地下室等 受外界环境或电磁干扰	移至开阔平坦地后，开机重试 避开可能引起频率干扰的设备

如上述方法仍未解决您的问题，或您遇到一些其他的故障，请联系当地经销商或我司以获取更多的技术支持。

保养与清洁

为了保证本产品发挥其良好性能，以及延长其使用寿命，请熟悉以下内容，以便更好地对本产品进行日常保养与清洁。

保养

- 请勿用硬物穿刺或刮花本产品。
- 请勿将本产品存放于含有腐蚀电子电路物质的环境。
- 携带或使用本产品过程中，请勿用手提天线或耳机线。
- 当不使用附件时，请盖好附件接口盖。

清洁



注意：清洁之前，请关机并取出电池。

- 请定期使用洁净干燥的无绒布或毛刷拭去本产品表面及充电极片附着的粉尘。
- 本产品的按键、控制旋钮和机壳极易变脏。可用中性洗涤剂和无纺布对其进行清洁，请勿用去污剂、酒精、喷雾剂或石油制剂等化学药剂进行清洁，以避免产品表面和外壳受损。
- 清洁之后，务必保证本产品彻底干燥，否则请勿使用。

选购配件

本产品主要的选购附件已包含在如下列表中，如需更多附件信息，请咨询您当地的经销商或拨打我司服务热线400-830-7020。



注意：请使用我司指定的配件。若擅自使用未经许可的配件，则由此所导致的一切后果，由用户自行负责。

配件类型	配件型号	配件名称
电源类	BL2503	电池 2500mAh (锂/镍氢) 电池MCU
	CH10A06	双插槽充电座套件 (含开关电源)
	CHV09	座充车载电源适配器
	MCA05	电池分析仪
	MCA06	锂电/镍电MCU快速排充
	MCA08	锂电/镍电MCU快速排充 (兼容薄电和厚电)
音频类	ADN-01	无线适配器
	EAN17	三线透明管监控耳机 (米色)
	EAN18	三线透明管监控耳机 (黑色)
	EAN23	分体式透明管耳机
	EHN16	分体式耳挂式耳机
	EHN17	分体可调节耳挂式耳机
	ESN12	分体式耳塞式耳机
	ESW01	无线耳机
	ESW01-N1	无线耳机套件
SM18N2	防水扬声器话筒 (IP57)	
线材类	PC38	编程连接线 (USB口)
携带类	LCBN13	手持终端通用尼龙胸包

保修范围与期限

我司承诺, 凡我司生产的产品, 自购买之日起, 在正常使用、操作与维护条件下, 出现材料或制造工艺方面的缺陷, 可享受以下规定的保修服务。

主机 24个月
 标配附件 (包括电池、充电座) 12个月

Hytera 

is the trademark or registered trademark of Hytera Communications Corporation Limited.
© 2018 Hytera Communications Corporation Limited. All Rights Reserved.

Address: HYT Tower, Hi-Tech Industrial Park North, Beihuan
RD., Nanshan District, Shenzhen, China
Postcode: 518057
<http://www.hytera.com>

Hytera 

是海能达通信股份有限公司的注册商标或商标
© 2018 海能达通信股份有限公司。版权所有

地址: 深圳市南山区北环大道9108号
邮编: 518057
服务热线: 400-830-7020
<http://www.hytera.com>

Z04313 H05658

